



27 Marsham Street, Westminster
London SW1P

GARTON JONES.COM



27 Marsham Street, Westminster
London, SW1P

GARTON JONES.COM

49 Marsham Street Sales +44 (0) 20 7340 0480
London westminster@gartonjones.com
SW1P 3DP www.gartonjones.com

£725 Per Week

A bright 2 bedroom apartment located on the 3rd floor (lift) of this small modern development. The property is offered furnished and benefits from an open plan integrated modern kitchen/ reception with access to a private balcony, there are 2 double bedrooms with the master benefitting from built in wardrobes and an en-suite and a further guest bathroom. Residents also benefit from a daytime porter. Marsham Street offers as an abundance of amenities and restaurants such as Osteria dell'Angolo, The Cinnamon Club, Visconti of Westminster (Italian Fine Dining & Cocktail Bar), the Ivy Bar and Grill and Yaatra based in the Old Westminster Fire Station. You are just a short walk away from the Chelsea College of Arts and St Johns Smith Square Concert Halls offering a variety of classical musical performances. The transport links of St James's Park, Westminster and Victoria are all within walking distance. The surrounding area offers an array of iconic landmarks which include the Houses of Parliament and Westminster Abbey. The local transport links of Victoria Station is nearby providing mainline UK services including the Gatwick Express as well as the underground services of Victoria, Pimlico, St James Park and Westminster. Garton Jones are located in the next to the development so are readily available for viewings.

5 Week Security Deposit
Minimum Term 12 Months
Westminster Council Tax Band G (£1150 Per Annum)

- Fantastic 2 Bedroom Apartment
- 3rd Floor (Lift)
- 832 Square Feet (77 Sq.M)
- Open Plan Reception Room
- Modern Kitchen
- 2 Bathrooms (En-Suite)
- Private Balcony
- Day Porter
- Close to Local Amenities Including Shops, Restaurants & Transport Links
- Walking Distance to Westminster, Pimlico, St James Park & Westminster Station



EPC certificate available on request.

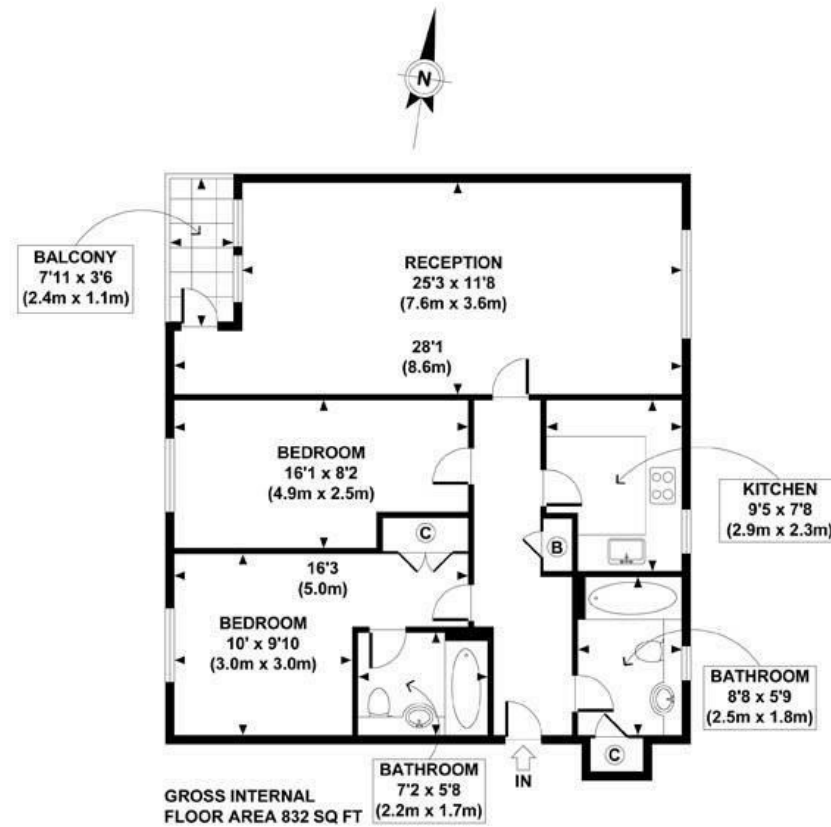

APPROX. GROSS INTERNAL FLOOR AREA 832 SQ FT / 77 SQ M
RHGJW - 120410 Copyright photoplan.co.uk
Floorplans are for identification and guideline purposes only, not to scale.
Compliant with RICS code of measuring practice.

